

IBIS GOLF AND COUNTRY CLUB

7517 HAWKS LANDING

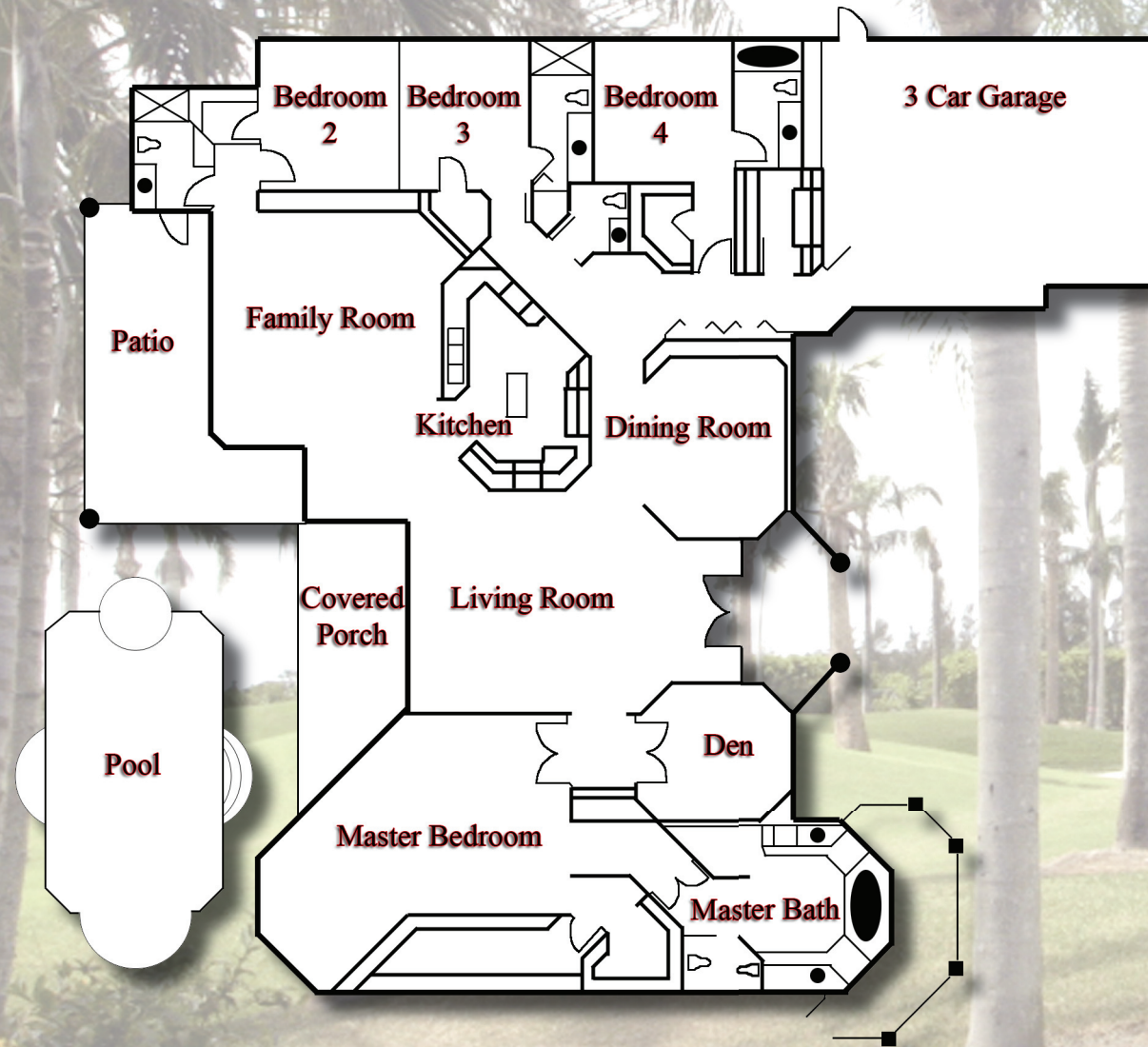

FLOOR PLAN



IBIS GOLF AND COUNTRY CLUB



4BR/4½BA + DEN/3CG

7517 HAWKS LANDING

ELEGANT, LUXURIOUS MEDITERRANEAN STYLE HOME FEATURES PANORAMIC GOLF COURSE VIEWS AND DESIGNER KITCHEN WITH 42" MAPLE CABINETS, GRANITE COUNTERS, AND MATCHING MAPLE EXHAUST FAN OVER THE GAS COOK TOP. SATURNIA MARBLE FLOORS THROUGHOUT THE LIVING AREAS, CUSTOM WINDOW TREATMENTS THROUGHOUT, BUILT IN STEREO SYSTEM AND SUMMER STAINLESS STEEL KITCHEN, YOU WILL FEEL RIGHT AT HOME. WITH A SCREENED AND HEATED POOL, SPA AND WATERFALL HEATED BY NATURAL GAS, AND AUTOMATIC POOL OVERFLOW AND REFILL, THE POOL AREA IS MAGNIFICENT. OTHER NOTABLES INCLUDE PAVERLOCK POOL PATIO AND DRIVEWAY, ELEGANT DINING ROOM WITH CUSTOM CHANDELIER, CROWN MOULDINGS, COFFERED CEILINGS, MULTIPLE HIHAT LIGHTS THROUGHOUT, AND HARDWOOD FLOORS IN MASTER BEDROOM AND HIS & HERS MASTER BEDROOM CLOSETS.

\$1,259,000 UNFURNISHED
\$1,289,000 FURNISHED

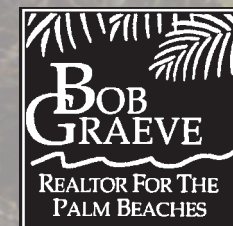

Robert Graeve, P.A., CRS
Certified Residential Specialist
Illustrated Properties Real Estate, Inc.



561-758-8571

bobgraeve@realtor.com

www.BobGraeve.com (virtual tours)

www.PalmBeachCountyRealEstate.com

Illustrated
Properties
Real Estate, Inc.