

Bay Hill Estates



8828 Marlamoore

LOCATED IN BAY HILL ESTATES, OVERLOOKING THE PGA NATIONAL ESTATES GOLF COURSE, THIS 6BR/3.5BA LUXURY HOME OFFERS EXCEPTIONAL FLORIDA LIVING WITH STUNNING GOLF COURSE AND WATER VIEWS. SKILLFULLY DESIGNED FLOOR PLAN IS WELL SUITED FOR FAMILIES AND THOSE WHO ENJOY LARGE OPEN SPACES AND GREAT VIEWS. THE KITCHEN OPENS INTO SPACIOUS FAMILY ROOM WITH A CUSTOM BUILT INS, FORMAL DINING & LIVING ROOM AND GRAND FOYER WITH AN INTRICATE MARBLE DESIGN. LIBRARY WITH MAPLE FLOOR, FRENCH DOORS AND ACCESS TO THE CABANA BATH. HOBBY ROOM OFF THE KITCHEN AND SPACIOUS PATIO WITH VIEWS OF THE GOLF COURSE.

6BR/3.5BA/3 CAR GAR. + LOFT

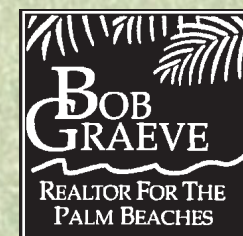

ILLUSTRATED PROPERTIES



Robert Graeve, P.A., CRS
 Certified Residential Specialist
 Illustrated Properties Real Estate, Inc.
 561-758-8571
bobgraeve@realtor.com
www.bobgraeve.com (virtual tours)
www.BayHillEstates.com



1st Floor

FIRST FLOOR LIVING	1,965 SF
SECOND FLOOR LIVING	1,808 SF
TOTAL LIVING	3,773 SF
3 CAR GARAGE	672 SF
COVERED & SCREENED PORCH	625 SF
COVERED ENTRY	66 SF
TOTAL COVERED	5,136 SF
SPRAY-DECK PATIO	875 SF
TOTAL W/PATIO	6,011 SF

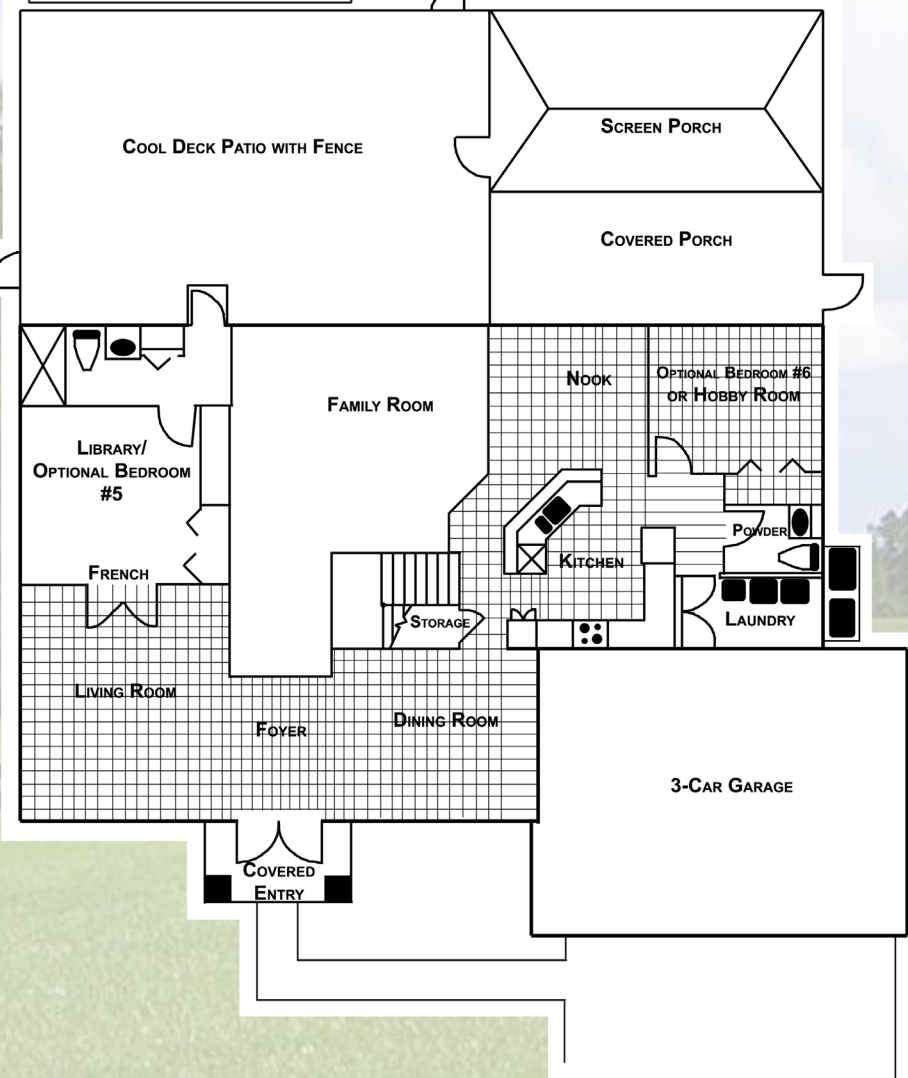

Floor Plan

2nd Floor

