

# BAY HILL ESTATES



**4BR/3½BA CUSTOM ESTATE HOME**

6032 SF LUXURY HOME FEATURES DRIVE THROUGH PORTE COCHE. 1.14 ACRES. SCENIC TREETED WATERFRONT CORNER LOT. LARGE COVERED AND SCREENED PATIO. GREAT WATER VIEWS. PLENTY OF ROOM FOR YOUR OWN CUSTOM DESIGNED POOL AND/OR TENNIS COURT.

11890 Leeth Ct.

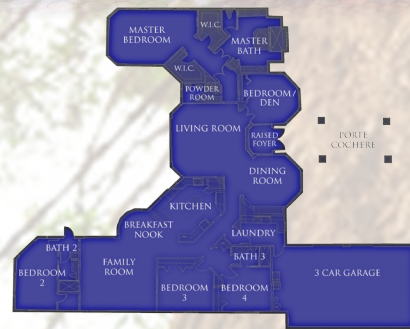

\$995,000

## FLOOR PLAN



Virtual Tours of ALL of these fine Bay Hill Estates Properties Available at [www.BayHillEstates.com](http://www.BayHillEstates.com)

Illustrated Properties Real Estate, Inc.  
10953 N Military Trail  
Palm Beach Gardens, FL 33410



WARM, INVITING KITCHEN



WATERFRONT



SCREENED, COVERED PATIO

# BAY HILL ESTATES BEST BUYS

11558 BUCKHAVEN LANE

4BR/4½BA/3CG



\$1,195,000

UNBELIEVABLE HOME! CONTEMPORARY EUROPEAN ELEGANCE! GORGEOUS WATER VIEW! 50' WRAP-AROUND HEATED POOL WITH HEATED SPA. DEN WITH BUILT IN CABINET.

## FLOOR PLAN

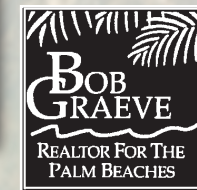
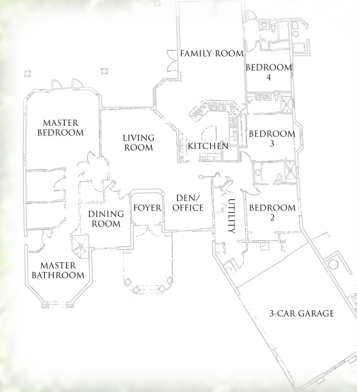

Robert Graeve, P.A., CRS  
Certified Residential Specialist  
Illustrated Properties Real Estate, Inc.  
**561-758-8571**  
[bobgraeve@realtor.com](mailto:bobgraeve@realtor.com)  
[www.BobGraeve.com](http://www.BobGraeve.com) (virtual tours)  
[www.PalmBeachCountyRealEstate.com](http://www.PalmBeachCountyRealEstate.com)



**Illustrated  
Properties**  
Real Estate, Inc.